



i3 MK3S Printable parts



Prusa Research

[VIEW IN BROWSER](#)

updated 4. 9. 2023 | published 9. 3. 2021

Summary

Original Prusa i3 MK3S Printable parts

[3D Printers](#) > [Prusa Parts & Upgrades](#)

All printable parts for your Original Prusa i3 MK3S.

Note these are the parts for the older MK3S version, not the newer MK3S+!

Some of the parts are not compatible! For MK3S+ parts, see the respective printable parts.

Attention, **y-rod-holder** is present 4 times in the printer. If you plan to print the whole kit, print this part 4x. Look for a number in the brackets in the file description.

Print instructions

PrusaSlicer's default PETG 0.2mm presets.

For **fan-shroud** part, please use Prusament ASA / PC-Blend with default settings and 5mm brim if necessary.

The fan-shroud STL file includes an inner support rim that needs to be removed after printing. It can be easily removed with needle-nose pliers, a knife, or flush cutters together with the brim. Otherwise, it will block most of the air from coming out. See the [corresponding assembly manual chapter](#) to see what the part should look like after removing the inner support.

ASA, PC Blend, PA or even ABS, as well as other high-temperature

materials are only suitable for experienced users, and being from different manufacturers, properties may vary greatly.

PLA or PET-G is a no-go for **fan-shroud** because of its low temperature resistance.

We recommend using black filament to print all MK3S+ extruder parts. If you want different colour, you can use it, but the **FS-lever** part should be definitely dark (black) and the other parts surrounding the IR-Sensor as well. In case you use any lighter colour for the **FS-lever** it might not trigger the sensor.

Model files



einsy-base.stl



adapter-printer.stl



einsy-hinges.stl



extruder-cable-clip.stl



extruder-idler.stl



cable-holder.stl



extruder-motor-plate.stl



heatbed-cable-cover.stl

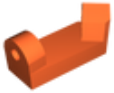

print-fan-support.stl

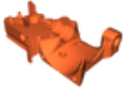

extruder-body.stl



fs-lever.stl



lcd-cover-original-mk3.stl



extruder-cover.stl



lcd-knob.stl



einsy-doors.stl



y-belt-tensioner.stl

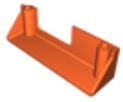

psu-cover-delta.stl

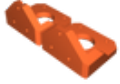

z-axis-bottom.stl



y-belt-holder.stl



x-end-idler.stl

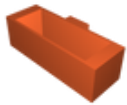

plug-aligner.stl



fs-cover.stl



x-end-motor.stl

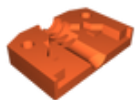

heatbed-cable-cover-clip.stl



heatbed-cable-clip.stl



lcd-supports.stl



y-rod-holder.stl



y-motor-holder.stl



y-belt-idler.stl



z-axis-top.stl



z-screw-cover.stl



fan-shroud.stl



x-carriage-back.stl

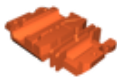

x-carriage.stl

License

This work is licensed under a
GNU



General Public License v2.0

- ✘ | Sharing without ATTRIBUTION
- ✓ | Remix Culture allowed
- ✓ | Commercial Use
- ✓ | Meets Open Definition
- i | Share under the same license